



Upper Swaines, Epping  
Guide Price £725,000

 4  1  2  D

MILLERS  
ESTATE AGENTS

**\* EXTENDED FAMILY HOME \* THREE RECEPTION AREAS \* FOUR BEDROOMS \* UTILITY & WC \* DETACHED GARAGE \* GATED PARKING \***

Situated on the popular residential street of Upper Swaines in Epping, this fabulous extended end terraced family home offers a perfect blend of space, comfort, and convenience. Spanning an impressive 1,346.1 square feet, the property features three inviting reception areas, four well-proportioned bedrooms and a modern bathroom, making it an ideal choice for families seeking both style and functionality.

Upon entering, you are greeted by a welcoming hallway that leads to a utility room and a separate store room. The front living room, complete with a charming fireplace, provides a cosy retreat, while the kitchen, dining area and snug are perfect for entertaining, boasting a set of double doors that seamlessly connect to the expansive rear garden. The first floor offers ample space on the landing leading to four double bedrooms. There is a family bathroom finished with a white three-piece suite.

The exterior of the property is equally impressive, with a front garden leading to the accommodation and gates allowing off-street parking for two or three vehicles. The rear garden, measuring over 50' x 40', is a true highlight, featuring a patio area ideal for alfresco dining with steps leading up to a low maintenance lawn area. Additionally, there is a detached garage offering a versatile space for storage or would make a fantastic home office.

Situated in a great location, this home is just a short walk from Epping's vibrant High Street, where you can enjoy a variety of shops, cafes, and amenities. This property is a wonderful opportunity for those looking to settle in a charming community while enjoying the comforts of a spacious family home. Easy access to Epping Central Line Station.





## GROUND FLOOR

### Porch

2'7" x 5'1" (0.79m x 1.55m)

### Living Room

17'7" x 10'11" (5.35m x 3.33m)

### Storage Area

5'1" x 5'5" (1.55m x 1.65m)

### Utility Room

5'5" x 10'10" (1.65m x 3.30m)

### Dining Room

11'1" x 9'7" (3.38m x 2.92m)

### Snug

12'4" x 5'9" (3.75m x 1.75m)

### Kitchen

8'4" x 9'7" (2.55m x 2.92m)

### Cloakroom

5'11" x 2'7" (1.80m x 0.79m)

## FIRST FLOOR

### Bedroom One

11'8" x 10'11" (3.56m x 3.34m)

### Bedroom Two

11'2" x 9'8" (3.40m x 2.95m)

### Bedroom Three

8'3" x 8'11" (2.51m x 2.72m)

### Bedroom Four

8'7" x 7'10" (2.62m x 2.40m)

### Bathroom

7'11" x 5'5" (2.41m x 1.65m)

## EXTERNAL AREA

### Detached Garage

15'8" x 7'8" (4.78m x 2.34m)

### Rear Garden (max)

50' x 40'9" (15.24m x 12.42m)



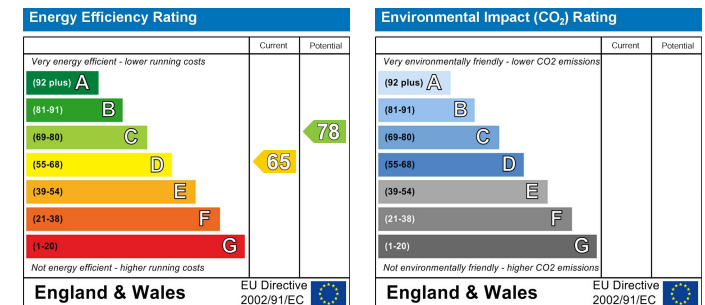
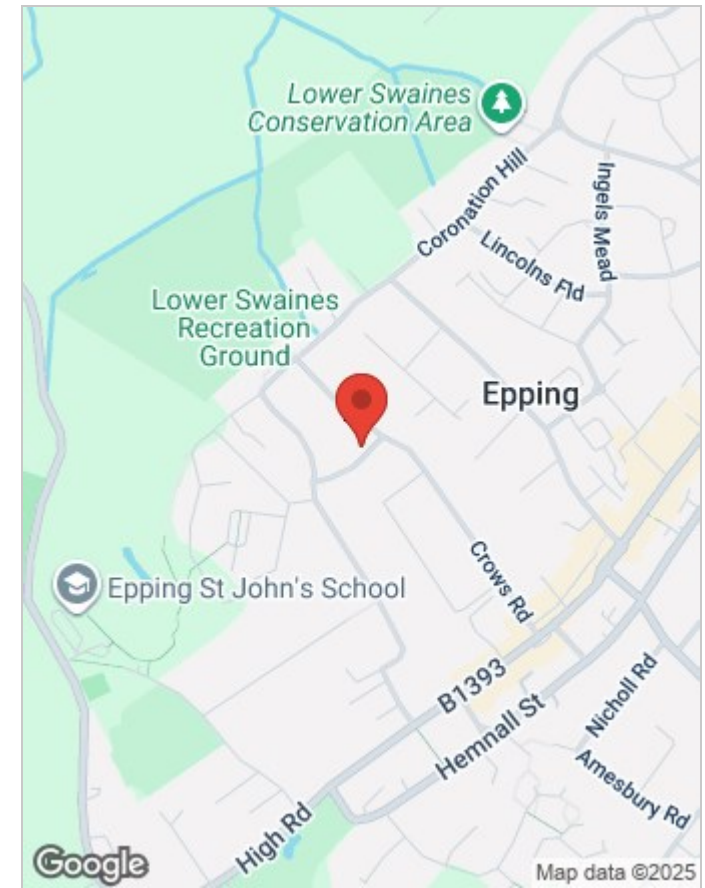
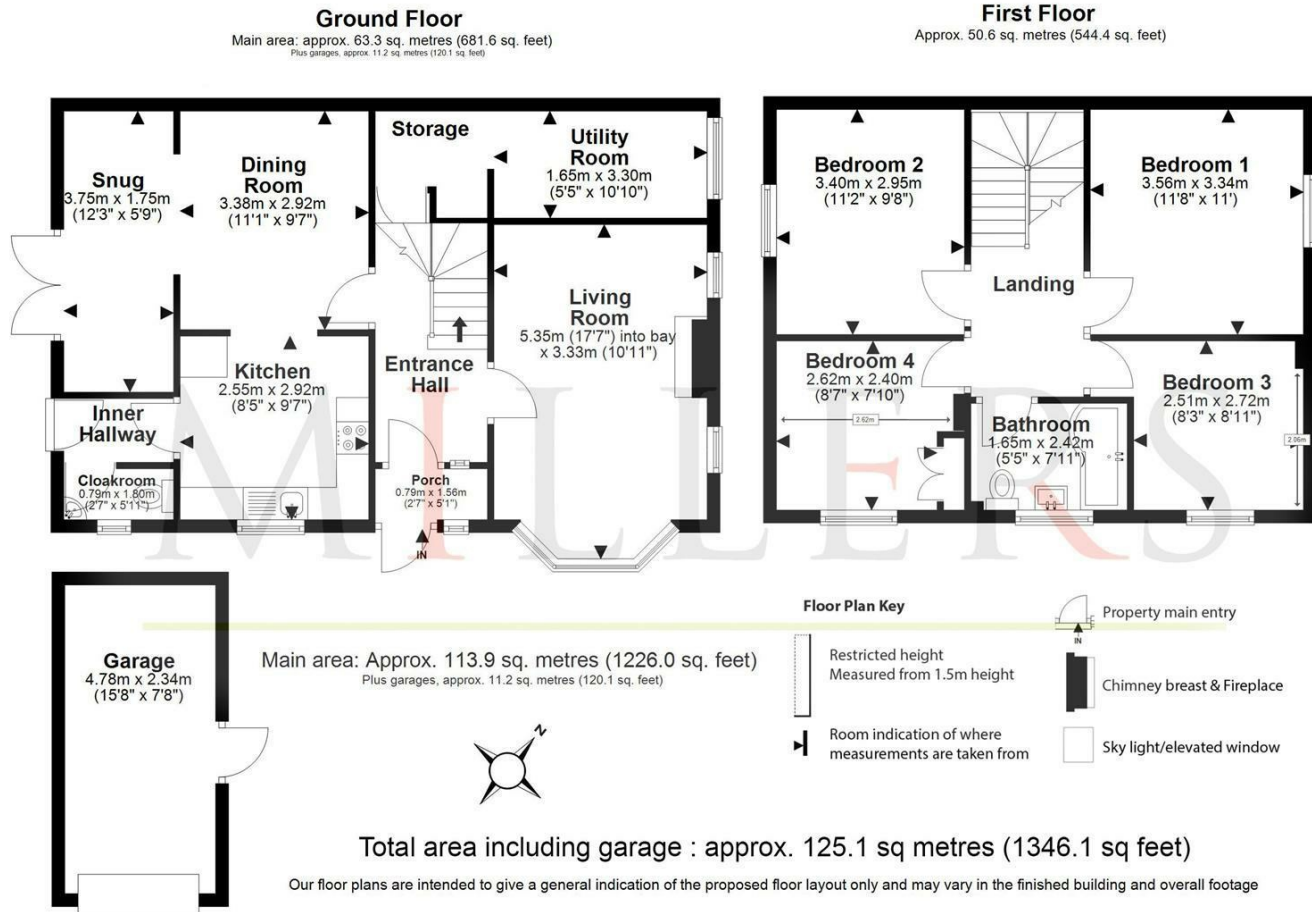

## Viewing

Please contact our Millers Office on 01992 560555 if you wish to arrange a viewing appointment for this property or require further information.

These particulars, whilst believed to be accurate are set out as a general outline only for guidance and do not constitute any part of an offer or contract. Intending purchasers should not rely on them as statements of representation of fact, but must satisfy themselves by inspection or otherwise as to their accuracy. No person in this firm's employment has the authority to make or give any representation or warranty in respect of the property.